

AXIAL FAN

axial fan motor										Type:
Motor:single phase motor with capacitor										Customer:
Motor type:MTA503RF										Customer type:
Type	Voltage V	Frequency Hz	Input power W	Current A	Speed r/min ±5%	Air volume m³/h	Noise level dBA	Capacitor μF/VDB		
MTA503RF	220	50	110	0.5	920	2480	58	4 μF/450V		

Insulation class : B					Operating type: S1					
Permissible ambient temperature : -30~60°C					Temperature increase: ΔT≤85k					
Motor protection:thermocontact 150±5°C					Bearings: ball bearings					
					License: CE					

Model meanings:

Asynchronism axial fan motor	YWF6E-400S	Direction of airflow
Motor pole		Fans diameter
Single Phase		

Electrical connection:lead wire 0.50mm	
Direction of rotation:clockwise(sucking),Airflow direction:"S" looking at rotor side	
High-voltage test according to EN 60335-1 1800V	
Material/Surface treatment:rotor with condensation drain holes varnished black, stator temperature protected	
Balance grade:G6.3 Fan balanced dynamically in two planes	

APPROX. WEIGHT	
MEANS	
DRN. BY	
CHD. BY	
ENG. BY	
APP. BY	
	A4
	SCALE
	SHEET: of

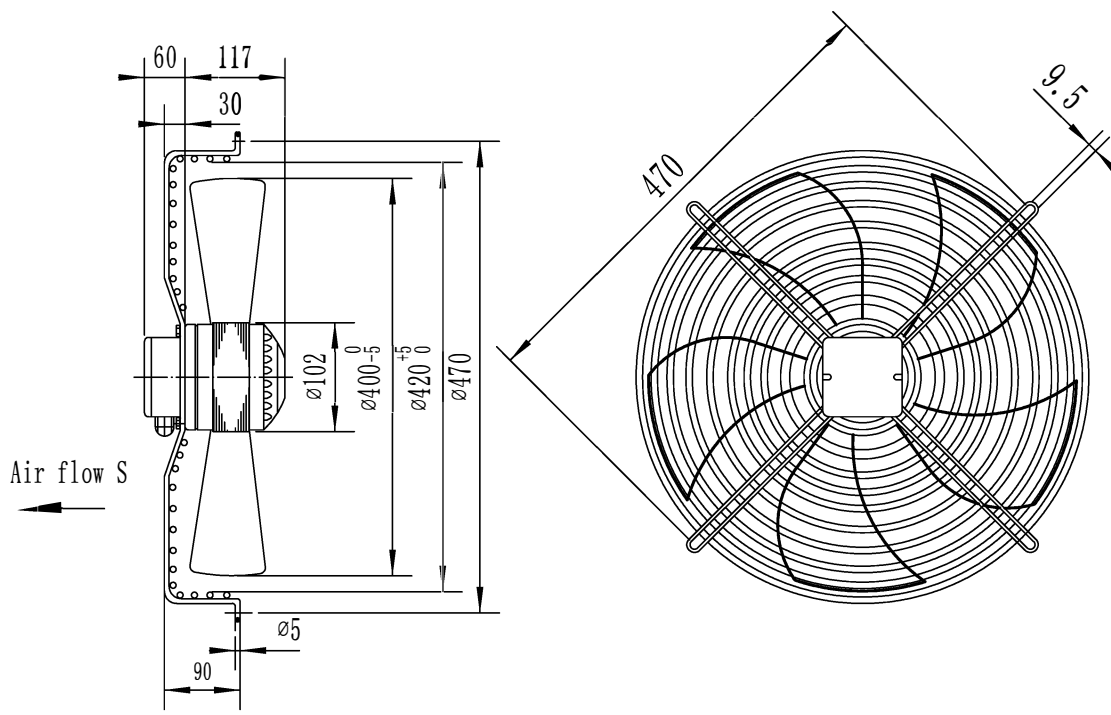

MTA503RF AXIAL FAN MOTOR
 220V 50Hz 0.5A 110W
 4 μF/450V 920r/min CL. B

