

AXIAL FAN

Unit:axial fan Type:
 Motor:single phase motor with capacitor Customer:
 Motor type:MTA602RF Customer type:

Type	Voltage V	Frequency Hz	Input power W	Current A	Speed r/min ±5%	Air volume m³/h	Noise level dBA	Capacitor μF/VDB
MTA602RF	220	50	80	0.4	950	1700	56	3 μF/450V

Insulation class : B Operating type: S1
 Permissible ambient temperature : -30~60°C Temperature increase: $\Delta T \leq 85k$
 Motor protection:thermocontact 150±5°C Bearings: ball bearings
 License: CE

Model meanings:
 Asynchronism axial fan motor — YWF6E-350B
 Motor pole —
 Single Phase — Direction of airflow
 Fans diameter

Electrical connection:lead wire 0.50mm
 Direction of rotation:clockwise(sucking),Airflow direction:"B" looking at rotor side
 High-voltage test according to EN 60335-1 1800V
 Material/Surface treatment:rotor with condensation drain holes varnished black,stator temperature protected
 Balance grade:G6.3 Fan balanced dynamically in two planes

APPROX. WEIGHT
 MEANS

DRN. BY			
CHD. BY			
ENG. BY			A4
APP. BY			SCALE
			SHEET: of

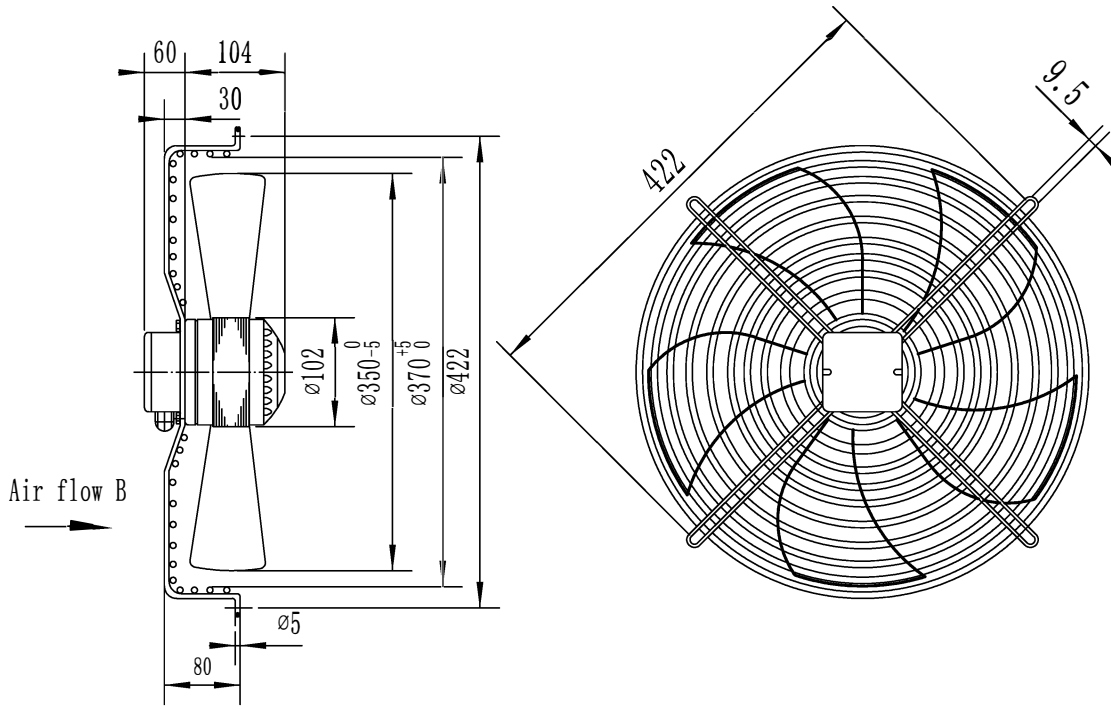

MTA602RF AXIAL FAN MOTOR
 220V 50Hz 0.4A 80W
 3 μF/450V 950r/min CL. B

