

3 holes M4×0.7EQUI-spced on Ø72 PCD on front and rear cover

CCW

WIRE CONNECT

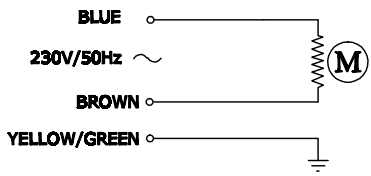

LABLE

**MTF526RF**  
 230V 50Hz 34/120W 0.75A  
 1300/1550r/min CL.B

SPECIFICATION	
MOTOR	Shaded pole motor
MOTOR TYPE	MTF526RF
VOLTAGE (V)	230
FREQUENCY (Hz)	50
INPUT POWER (W)	120W
CURRENT (A)	0.75A
SPEED (RPM)	1300RPM
FAN BLADES	
ROTATION	CCW (looking towards the shaft)
AIRFLOW DIRECTION	Sucking or Blowing
MOTOR PROTECTION	Impedance protected
INSULATION CLASS	B
TEMPERATURE RISE	75°C max (with load)
PROTECTION CLASS	IP 42
OPERATING TYPE	S1
MOUNTING TYPE	Horizontal or Vertical
AMBIENT TEMPERATURE	-40°C +40°C
BEARINGS	Sleeve bearings
LUBRICATING OIL	PERMAWICK 284#
ELECTRICAL CONNECTION	VDE 3× 0.3mm <sup>2</sup> lead wire 1000-1020mm free length
HI-POT TEST	1800V 1S
RING	
GRID	
BRACKER TYPE	
APPROVALS	CE
WEIGHT PER UNIT	2kg
PACKING	12PCS/CTN
P/N	

REV.	DESCRIPTION	APPROVED	DATE	DECIMAL	TOLERANCE	DRN.BY	SIGN	DATE	TITLE
				X	±0.5				FAN MOTOR 34W
				X.X	±0.25				
				X.XX	±0.15				
				ANGLE	±3°	APP.BY			PROJECTION

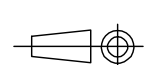

A4  
 SCALE:  
 SHEET: of