

## HOW TO CHOOSE A PROPER CONDENSATE PUMP

### Identifying air-conditioning unit type

As there are varieties of pump models available for different unit types such as split, ducted, floor mounted, cassettes, etc., it is very important to identify the type of cooling system while choosing the suitable condensate pump.



### Cooling capacity of the air-conditioner

The AC cooling capacity (often represented in kWh and can be found in your AC specifications) is needed to estimate the amount of condensate discharged per hour (1kWh cooling load will generate about 0.4-0.8L/h). ACs with larger cooling capacities tend to generate more condensate than regular ones.



### The discharge head

Figure out the lift requirement for the pump by identifying where the pump will be mounted and where the discharge point will be. Condensate flow will decrease in accordance with the height it must travel until maximum, or "shut-off" lift is reached. Select a pump with a maximum lift rating that is suitable for your application.

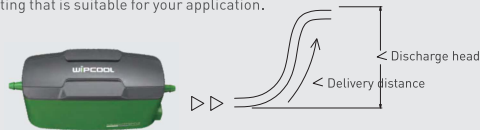

### Climate

Along with cooling capacity, location and climate also play a big role in measuring the amount of condensate. The discharge quantity can differ significantly between dry and humid climates. For example, the quantity of condensate in humid climates can double that of dry climates. Therefore, you need a higher performance pump for humid climatic conditions.

## WIPCOOL CONDENSATE PUMP'S SELECTION

Model	Max. unit output	Applicable A/C	Applicable place	Discharge head [Max]
P18	30000Btu/h	Split unit, Floor mounted unit	Smaller commercial and domestic units in quiet environments	10m
P36	45000Bth/h			
P16	30000Btu/h	Ducted units; Floor standing & Chassis units; High wall split systems		
P32	45000Bth/h			
P12	30000Bth/h			
P12C	30000Bth/h	High wall split systems		
P180	300,000Bth/h	Floor mounted unit, Dehumidifiers; Air handling units (AHUs)	Large commercial units	4.5m
P380	500,000Bth/h			6.8m
P580	500,000Bth/h			12m

### Cooling capacity conversion

1Btu/h=0.2931W, 1W=3.412Btu/h

1USRT=3.517kW, 1kW=0.28434USRT

## Wall-Mounted Condensate Pump

P18 P36

### Dual Guarantee, High Security

- High performance brushless motor, strong power
- Level gauge installed, ensure the accurate installation
- Dual-control system, improve durability
- Built-in LEDs provide visual operating feedback

#### INSTRUCTIONS



#### FEATURES



Dual-control system(probe&float)



Buzzer fault alarm



Led running light



Easy access to installation

#### DIMENSIONS

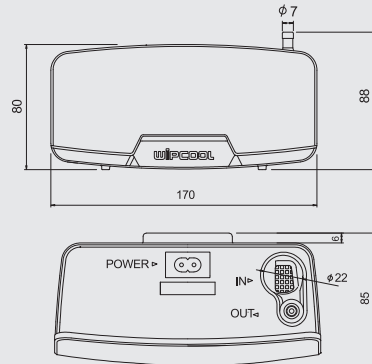

#### FLOW RATE

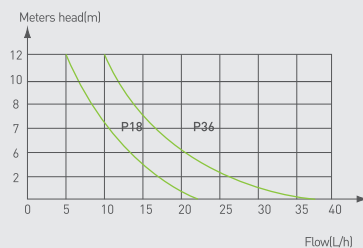

## Mini Condensate Pump

P16 P32

### Silent Running, Reliable and Durable

- Super quiet design, Unequalled operating sound level
- Built-in safty switch, improve reliability
- Exquisite&compact design, Suitable for different spaces
- Built-in LEDs provide visual operating feedback

#### INSTRUCTIONS

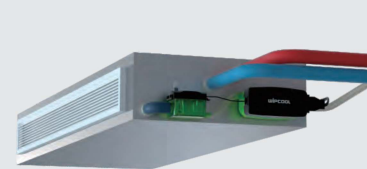

#### FEATURES

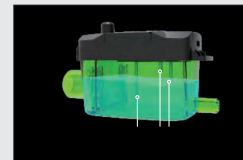

3 level sensor technology



Split structure, flexible installation



Led running light



Built-in safty switch

#### DIMENSIONS

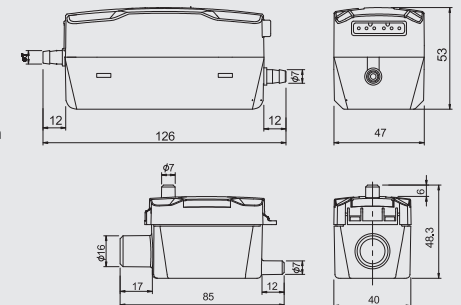

#### TECHNICAL DATA :

Model	P16	P32
Voltage	100V-230V~/50-60Hz	
Discharge Head(max.)	10m(33ft)	
Flow Rate(max.)	16L/h(4.2GPH)	32L/h(8.5GPH)
Tank Capacity	35ml	
Mini Splits up to	30,000btu/hr	45,000btu/hr
Sound Level at 1m	19dB(A)	21dB(A)
Ambient Temp.	0°C~50°C	

#### FLOW RATE

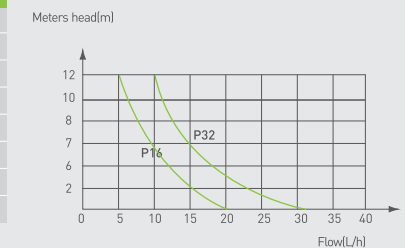

## Mini Condensate Pump Compact and Flexible, Silent and Durable

- Compact ,flexible installation
- Quick- connect , convenient maintenance
- Unique motor balance technology, reduce vibration
- High quality denoise design, better user experience

P12



### DIMENSIONS

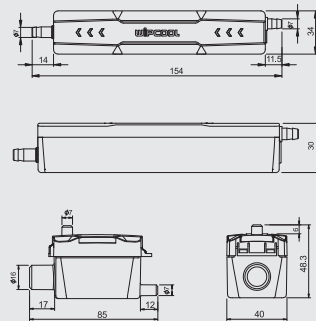

### INSTRUCTIONS



Can be installed inside of A/C

TECHNICAL DATA :	
Model	P12
Voltage	100V-230V~/50-60Hz
Discharge Head(max.)	7m(23ft)
Flow Rate(max.)	12L/h(3.2GPH)
Tank Capacity	35 ml
Mini Splits up to	30,000btu/hr
Sound Level at 1m	19dB(A)
Ambient Temp.	0°C-50°C

### FLOW RATE

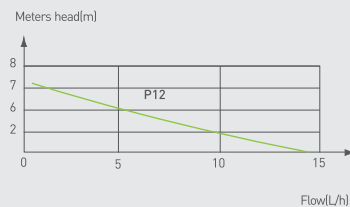

## Corner Condensate Pump Reliable and Durable Silence Running

- Integral design, compact
- Connect the socket quickly, easy maintenance
- Easy installation
- Quiet and no vibration

P12C



### DIMENSIONS

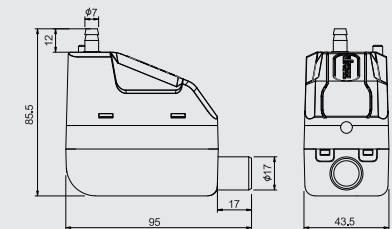

### INSTRUCTIONS



Can be installed in right side



Can be installed on left sides

TECHNICAL DATA :	
Model	P12C
Voltage	100V-230V~/50-60Hz
Discharge Head(max.)	7m(23ft)
Flow Rate(max.)	12L/h(3.2GPH)
Tank Capacity	45 ml
Mini Splits up to	30,000btu/hr
Sound Level at 1m	19dB(A)
Ambient Temp.	0°C-50°C

### FLOW RATE

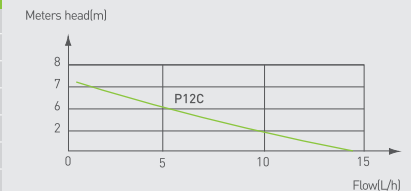

## Tank Condensate Pump

### Reliable Operation Simple Maintenance

- Floatless structure, free maintenance for long time work
- Automatic reset thermal protection, longer service life
- Forced air cooling, ensure stable running
- Anti-backflow design, improve the safety



P180

#### DIMENSIONS

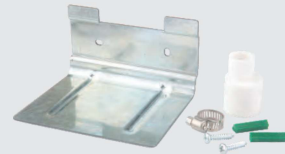
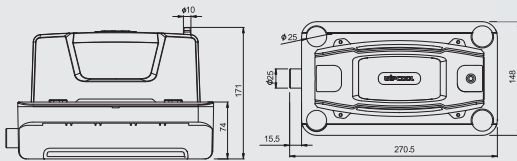

#### INSTRUCTIONS



#### FLOW RATE

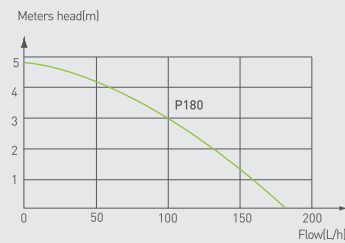

#### TECHNICAL DATA :

Model	P180	Tank Capacity	1.8 L
Voltage	230V~/50-60Hz or 115V~/50-60Hz	Sound Level at 1m	48dB(A)
Discharge Head(max.)	4.5m(15ft)	Ambient Temp.	0°C~50°C
Flow Rate(max.)	180L/h(48GPH)	Power Consumption	60W

## Tank Condensate Pump

### Higher Discharge Head Convenient Installation

- Buckle type fixed structure, easy installation
- 3 inlets for optional, easy to use
- Buzzer fault alarm, improve the safety
- Low profile for limited spaces



P380

#### DIMENSIONS

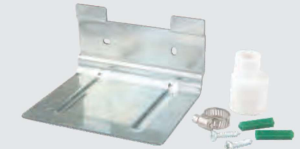
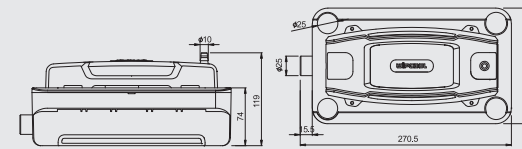

#### INSTRUCTIONS



#### FLOW RATE

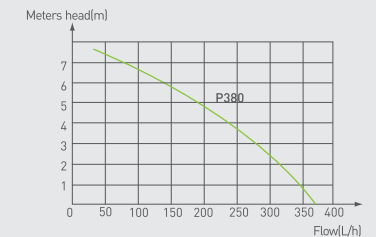

#### TECHNICAL DATA :

Model	P380	Tank Capacity	1.8L
Voltage	100V-230V~/50-60Hz	Sound Level at 1m	28dB(A)
Discharge Head(max.)	6.8m(22ft)	Ambient Temp.	0°C~50°C
Flow Rate(max.)	380L/h(100GPH)	Power Consumption	20W

## Tank Condensate Pump

### Ultra-high Lift, Super Big Flow

- Super performance(12M lift,580L/h flowrate)
- Forced air cooling , ensure stable running
- Anti-backflow design,improve the safety
- Floatless structure, free maintenance for long time work



P580

#### DIMENSIONS

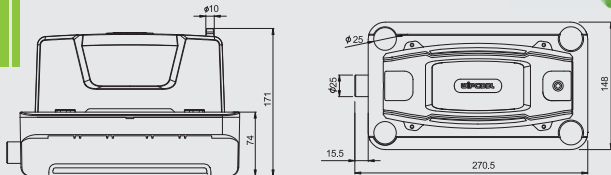

#### INSTRUCTIONS



#### TECHNICAL DATA :

Model	P580	Tank Capacity	1.8 L
Voltage	230V~/50-60Hz or 115V~/50-60Hz	Sound Level at 1m	60dB(A)
Discharge Head(max.)	12m(40ft)	Ambient Temp.	0°C~50°C
Flow Rate(max.)	580L/h(153GPH)	Power Consumption	85W

#### FLOW RATE

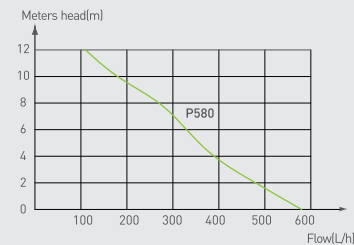

## Supermarket Condensate Pump

### Special Design, Simple Installation

- Made of stainless steel case with 3L large reservoir
- Ideal for cold produce display cabinets in supermarkets and convenience stores
- Low profile (70mm height) for extremely easy to install and maintain.
- Built of heat resistant material,suitable for handling 70°C high temperature water



P120S

#### INSTRUCTIONS



#### DIMENSIONS

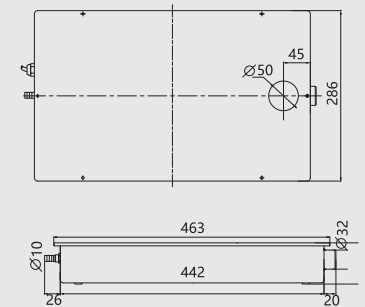

#### TECHNICAL DATA :

Model	P120S
Voltage	230V~/50-60Hz or 100-120V~/50-60Hz
Discharge Head(max.)	Max,30M(98ft)
Flow Rate(max.)	Max,120L/h(32GPH)
Tank Capacity	3L
Sound Level at 1m	40~62dB(A)
Water Temp.	Max 75°C
Power	30W

#### FLOW RATE

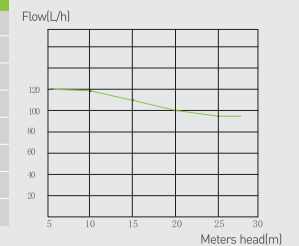

## Supermarket Condensate Pump Lightweight Design, Reliable & Durable

P360S

- Made of robust plastic, effectively pumps away defrost water and filters debris.
- Ideal for cold produce display cabinets in supermarkets and convenience stores
- Built-in high level safety switch which will either enable the plant to be switched off or sound an alarm in the event of a pump failure.



### INSTRUCTIONS



### DIMENSIONS

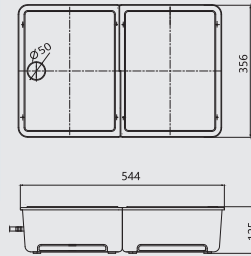

### TECHNICAL DATA :

Model	P360S
Voltage	230V~/50-60Hz or 100-120V~/50-60Hz
Discharge Head(max.)	Max.36M(118ft)
Flow Rate(max.)	Max.360L/h(95GPH)
Tank Capacity	11L
Sound Level at 1m	60dB(A)
Water Temp.	0-40°C
Power	80W

### FLOW RATE

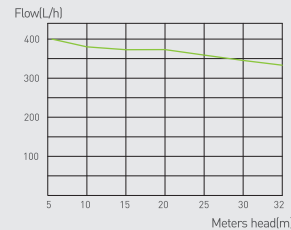

## Condensate Atomization Pump

P15J

## Create Wealth From Waste Energy Saving & CO2 Emission

- Stop condensate water's dripping and free of condensate pipe's installation
- Increased the heat rejection by water evaporation absorbs a lot of heat
- Enhanced refrigeration effect of the system obviously, saving the energy



### INSTRUCTIONS



### TECHNICAL DATA :

Model:	P15J	Tank Capacity:	35ml
Voltage:	230V~/50-60Hz 100-120V~/50-60Hz	Mini Splits up to:	45,000btu/hr
Flowrate:	15L/h(2 nozzles)	Sound Level at 1m:	30dB(A)
Pressure:	9bar	Power:	35W
Delivery hose length:	3m	Ambient Temp:	0-50°C

## Intelligent Level Controller Intelligent Security

- Built in indicator - provide visual operating feedback
- Sensitive control - cut off power supply automatically in case of drainage failure
- Easy to install - Suitable for all WIPCOOL condensate pumps which have built-in safety switch



PLC-1

### INSTRUCTIONS



Normal drainage status-All devices are working normally



Failure drainage status-Output was cut off when water reaches alarm level to trigger safety switch, To prevent refrigeration equipment continues to generating the condensate water

### WIRING DIAGRAMS

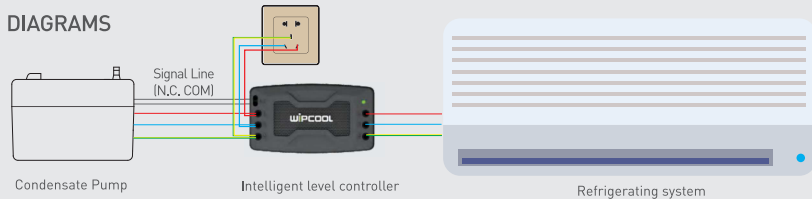

### TECHNICAL DATA :

Model	PLC-1
Power of applicable equipment (maximum)	3000W
Max Carry Current	16A

### DIMENSIONS

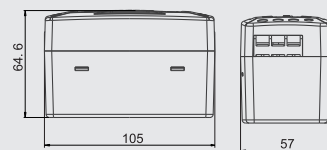

## Floating-ball Condensate Trap Smooth drainage, Enjoy fresh air

- Lightweight design, easy to install
- Anti blockage, prevent smelly & insect-resistant
- Controlled by floating ball valve, Suitable for all seasons
- No need to inject water when it is dry
- Buckle design, easy to maintain and clean



Installed in drainage pipe

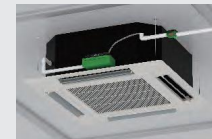

Used with condensate pump

### DIMENSIONS

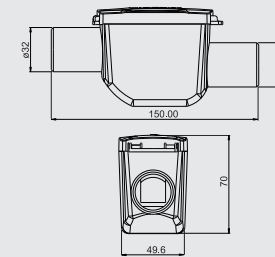

### TECHNICAL DATA :

Model	PT-25
Inner diameter	φ25
Outer diameter	φ32
Negative pressure	1200Pa
Gross weight	115g

PT-25



Anti-dew device

### Exploded figure



Cover



Gasket



Floating-ball



Internal chamber



Main body

## Condensate Drain Tubing

### Flexible, durable and non toxic



DT-1 PVC tubing



DT-2 PVC tubing



DT-3 Insulation tubing

### TECHNICAL DATA :

Model	DT-1	DT-2	DT-3
Material	PVC	PVC	PVC+PE
Size	φ6mm x φ9mm	φ8mm x φ12mm	φ6mm x φ9mm
Length	100m	100m	50m